

# BLUETOOTH/SETUP MENU QUICK REFERENCE GUIDE **GENESIS Coupe**

## VOICE COMMAND MENU

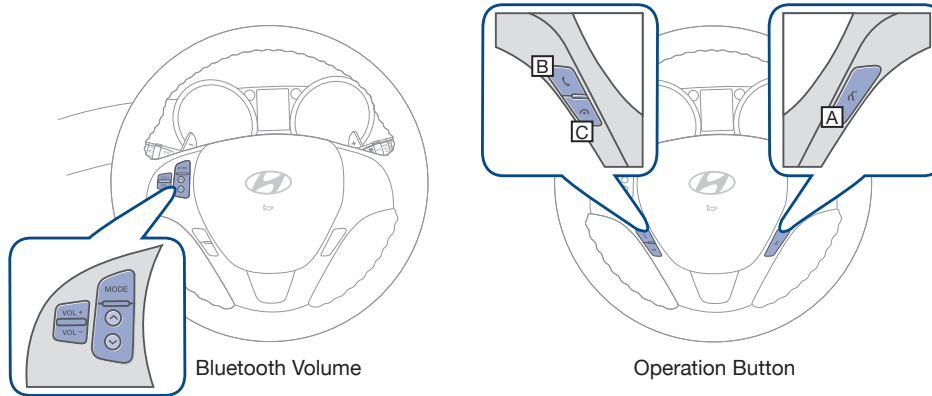

First press the Voice Command button **A** then...  
Say

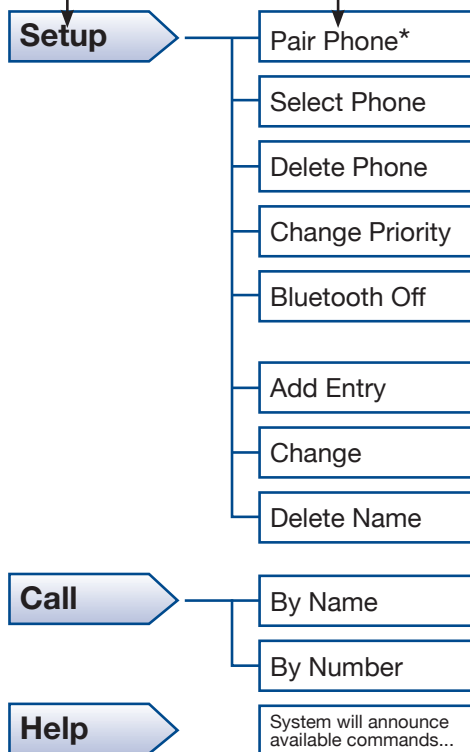

## BLUETOOTH HANDS-FREE PHONE USE



### Pairing your phone

Follow these steps to connect your Bluetooth cell phone using Voice Command\*.

**NOTE:** Do not pair phone while driving.

- Press the Voice Command button **A**.
- Then say "SET UP".
- Say "PAIR A PHONE".
- Say "YES".
- Say a "NAME" for the phone.
- Start pairing your cell phone to Bluetooth with PIN code provided (0, 0, 0, 0). Make sure your Bluetooth is "ON" on your cell phone before pairing.

### Dialing a number

- Press the Voice Command button **A**.
- Then say "CALL/DIAL".  
CALL – If dialing by name  
DIAL – If dialing by number

### Receiving incoming call

- Press the Phone button **B**.
- To refuse a call press End button **C**.

\*Please refer to your Owner's Manual for more detailed information on how to use your Bluetooth® System.

### Transferring a Call to Your Cell Phone (Privacy Mode)

- Press and hold the PHONE button **B** (Not while driving)

### Adjusting Ring/Bluetooth Volume Level

- Push '+' or '-' on steering wheel volume control or use audio volume knob to adjust volume level

### Accepting/Declining 2<sup>nd</sup> Call

- To Accept 2<sup>nd</sup> call (while putting 1<sup>st</sup> call on HOLD), press the PHONE **B** button to take the call. When the 2<sup>nd</sup> call is no longer active, the 1<sup>st</sup> call will RESUME.
- To Decline 2<sup>nd</sup> call, press the END **C** button to refuse the call

# BLUETOOTH/SETUP MENU QUICK REFERENCE GUIDE **GENESIS Coupe**

## VEHICLE SETUP MENU



The Vehicle Setup Menu allows access to certain system functions and customization of certain display characteristics. The Vehicle Setup Menu is managed using the audio system control buttons.

To access the Vehicle Setup Menu:

- The audio system power **A** has to be on for the Setup Menus to be displayed
- Press the “Setup” button **B**
- Use the Seek/Track or Tune/File buttons **C** to scroll up or down through the menu items
- To access a desired menu function press the “Enter” button **D**

### SETUP MENU ITEMS (Viewed in display **E**)

- **SOUND**—allows access to audio Equalizer functions
- **BLUETOOTH**—an alternative to using the steering wheel-mounted Voice Recognition controls to pair a mobile phone (see page 1 of this guide for Voice Recognition procedures)
- **SCROLL**—enables the scrolling of XM Radio display text that extends outside the display screen
- **TEMPERATURE**—sets the temperature displays to Fahrenheit or Centigrade units
- **CLOCK**—allows resetting of the Display clock
- **AUTOMATIC VOLUME CONTROL (or AVC)**—turns the audio system’s speed-sensitive volume adjustment on or off
- **XM**—offers the choice to display either XM Category and Channel—or Artist and Song Title
- **RETURN**—cancels the Setup function and returns the Display to normal function. A second press of the Setup button does the same thing.

### LANGUAGES

The system can use any of three different languages...

- English
- French
- Spanish

To change to the next language, hold the steering wheel Voice Command button for approximately 10 seconds. This operation is required for each change of language.

